

C-MOUNT
1.1" 12MP

1.1" 12 MEGAPIXEL C-MOUNT LENS

MACHINE VISION LENS

- 8, 12, 16, 25, 35, 50mm. 6 Lens Series
- Compatible with 1.1" (φ 17.6mm) Large Format Sensor

- Ultra-High Resolution 12MP
- Compact 1.1" Design (smallest 12MP lens in the industry)

NEW

V0828-MPY

1.1"

12MP

FIX

MANUAL

FLOATING

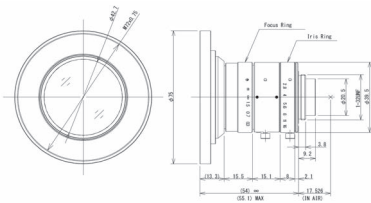

Focal Length	8mm	
Max. Aperture Ratio	1:2.8	
Max. Image Format	14.2mm x 10.4mm (φ 17.6mm)	
Operation Range	Iris	F2.8 - F16.0
	Focus	0.2m - Inf.
Control	Iris	Manual
	Focus	Manual
Object Dimension at M.O.D.	375.6(H)mm x 273.3(V)mm 1.1"	
Angle of View	D	93.9°
	H	83.0°
	V	66.0°
Operating Temperature	1.1"	89.3°
	1"	77.3°
	2/3"	69.0°
Operating Temperature	1.1"	61.7°
	1"	44.2°
	2/3"	44.2°

Distortion	1.1" -0.6%(y=8.8)	1" -1.7%(y=8.0)	2/3" -2.8%(y=5.5)
Back Focal Length	8.6mm		
Flange Back Length	17.526mm		
Mount	C-Mount		
Filter Size	M72 P=0.75mm (with VM0811)*		
	M67 P=0.75mm (with VM0810)*		
Dimensions	φ 75mm x 54mm		
Weight	155g		

*There is no filter mount on the top of the lens.
For using filters, please attach either VM0811 or VM0810.
For more detail, please refer to P22.

Working Distance (mm)	Optical Magnification	Extension Ring (mm)	Field of View(mm)					
			1.1"		1"		2/3"	
			H	V	H	V	H	V
1000	0.008	-	1790.8	1310.2	1617.6	1206.7	1103.1	820.5
950	0.009	-	1702.4	1245.4	1537.7	1147.0	1048.6	780.0
900	0.009	-	1614.2	1180.9	1458.0	1087.5	994.2	739.5
850	0.010	-	1525.9	1116.2	1378.2	1027.9	939.7	699.0
800	0.010	-	1437.5	1051.4	1298.3	968.3	885.2	658.4
750	0.011	-	1348.8	986.4	1218.0	908.3	830.4	617.6
700	0.012	-	1260.1	921.4	1137.9	848.5	775.7	576.9
650	0.013	-	1172.0	856.8	1058.2	789.0	721.3	536.5
600	0.014	-	1083.5	792.0	978.3	729.3	666.7	495.9
550	0.015	-	995.2	727.3	898.5	669.7	612.2	455.3
500	0.016	-	906.4	662.2	818.2	609.8	557.4	414.6
450	0.018	-	817.8	597.3	738.1	550.0	502.8	373.9
400	0.020	-	729.5	532.6	658.3	490.4	448.3	333.3
350	0.023	-	641.0	467.7	578.3	430.7	393.6	292.7
300	0.027	-	552.1	402.6	497.9	370.6	338.8	251.9
250	0.032	-	463.7	337.9	418.0	311.0	284.3	211.3
200	0.039	-	375.6	273.3	338.4	251.6	229.9	170.9
150	0.051	0.2	287.1	208.5	258.4	191.9	175.3	130.3
100	0.075	0.2	198.5	143.7	178.4	132.2	120.8	89.7

Field of View = CCD Size / Optical Magnification

NEW

V1228-MPY

1.1"

12MP

FIX

MANUAL

FLOATING

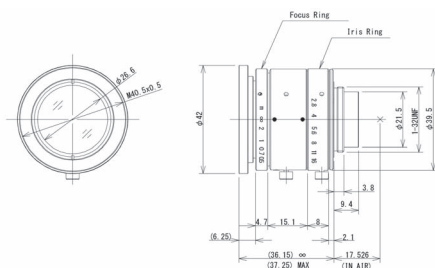

Focal Length	12mm	
Max. Aperture Ratio	1:2.8	
Max. Image Format	14.2mm x 10.4mm (φ 17.6mm)	
Operation Range	Iris	F2.8 - F16.0
	Focus	0.3m - Inf.
Control	Iris	Manual
	Focus	Manual
Object Dimension at M.O.D.	351.6(H)mm x 257.0(V)mm 1.1"	
Angle of View	D	71.1°
	H	60.5°
	V	46.2°
Operating Temperature	1.1"	66.4°
	1"	55.5°
	2/3"	42.9°
Operating Temperature	1.1"	48.6°
	1"	39.6°
	2/3"	30.1°

Distortion	1.1" -0.5%(y=8.8)	1" -1.0%(y=8.0)	2/3" -1.4%(y=5.5)
Back Focal Length	8.4mm		
Flange Back Length	17.526mm		
Mount	C-Mount		
Filter Size	M40.5 P=0.5mm		
Dimensions	φ 42.0mm x 36.1mm		
Weight	98g		

Working Distance (mm)	Optical Magnification	Extension Ring (mm)	Field of View(mm)					
			1.1"		1"		2/3"	
			H	V	H	V	H	V
1000	0.012	-	1167.9	854.2	1053.4	787.5	720.9	538.6
950	0.013	-	1109.5	811.4	1000.7	748.1	684.8	511.6
900	0.014	-	1051.2	768.8	948.2	708.8	648.9	484.8
850	0.015	-	992.9	726.1	895.5	669.4	612.8	457.8
800	0.015	-	934.6	683.4	842.9	630.1	576.8	430.9
750	0.016	-	876.4	640.9	790.4	590.9	540.9	404.1
700	0.018	-	818.0	598.1	737.7	551.5	504.8	377.1
650	0.019	-	759.7	555.5	685.1	512.2	468.8	350.3
600	0.021	-	701.5	512.9	632.7	472.9	432.9	323.4
550	0.022	-	643.0	470.2	579.9	433.5	396.8	296.5
500	0.025	-	584.7	427.5	527.3	394.2	360.8	269.6
450	0.027	-	526.5	384.9	474.8	354.9	324.9	242.7
400	0.031	-	468.2	342.3	422.2	315.6	288.9	215.8
350	0.035	-	409.9	299.7	369.6	276.3	252.9	189.0
300	0.041	-	351.6	257.0	317.0	237.0	216.9	162.1
250	0.048	0.5	303.1	221.0	273.0	203.7	186.4	139.2
200	0.060	0.5	242.7	177.0	218.6	163.1	149.3	111.5
150	0.079	0.5	182.5	133.1	164.3	122.6	112.2	83.8
100	0.115	1.0	126.3	91.9	113.6	84.7	77.5	57.8

Field of View = CCD Size / Optical Magnification

NEW

V1628-MPY

- 1.1"
- 12MP
- FIX
- MANUAL
- FLOATING

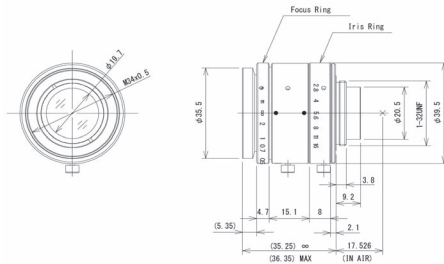

Focal Length	16mm			
Max. Aperture Ratio	1:2.8			
Max. Image Format	14.2mm x 10.4mm (φ 17.6mm)			
Operation Range	Iris F2.8 - F16.0			
	Focus 0.3m - Inf.			
Control	Iris Manual			
	Focus Manual			
Object Dimension at M.O.D.	264.6(H)mm x 193.8(V)mm 1.1"			
Angle of View	D	57.9°	53.4°	38.2°
	H	1.1" 48.2°	1" 43.9°	2/3" 30.9°
	V	36.2°	33.6°	23.4°
Operating Temperature	-10°C ~ +50°C			

Distortion	1.1" -0.5%(y=8.8)	1" -0.6%(y=8.0)	2/3" -0.6%(y=5.5)
Back Focal Length	9.4mm		
Flange Back Length	17.526mm		
Mount	C-Mount		
Filter Size	M34.0 P=0.5mm		
Dimensions	φ 39.5mm x 35.2mm		
Weight	91g		

Working Distance (mm)	Optical Magnification	Extension Ring (mm)	Field of View(mm)					
			1.1"		1"		2/3"	
			H	V	H	V	H	V
1000	0.016	-	890.1	651.4	802.4	601.0	550.7	412.4
950	0.017	-	845.4	618.7	762.1	570.9	523.0	391.7
900	0.018	-	800.7	586.0	721.8	540.7	495.4	371.0
850	0.019	-	756.2	553.5	681.7	510.7	467.9	350.5
800	0.020	-	711.5	520.8	641.5	480.5	440.3	329.8
750	0.021	-	666.9	488.1	601.2	450.4	412.7	309.1
700	0.023	-	622.2	455.4	560.9	420.2	385.0	288.4
650	0.025	-	577.4	422.7	520.6	390.0	357.4	267.7
600	0.027	-	532.7	390.0	480.3	359.9	329.7	247.0
550	0.029	-	488.1	357.3	440.0	329.7	302.1	226.3
500	0.032	-	443.4	324.6	399.8	299.6	274.5	205.6
450	0.036	-	398.7	291.9	359.5	269.4	246.9	184.9
400	0.040	-	353.9	259.2	319.2	239.2	219.2	164.2
350	0.046	-	309.3	226.5	278.9	209.1	191.6	143.5
300	0.054	-	264.6	193.8	238.6	178.9	163.9	122.8
250	0.063	1.0	227.8	166.3	205.1	153.3	140.5	105.1
200	0.079	1.0	181.4	132.5	163.4	122.2	111.9	83.8
150	0.106	1.0	135.1	98.8	121.7	91.1	83.5	62.5
100	0.156	2.0	92.1	67.2	82.9	61.9	56.7	42.5

Field of View = CCD Size / Optical Magnification

NEW

V2528-MPY

- 1.1"
- 12MP
- FIX
- MANUAL
- FLOATING

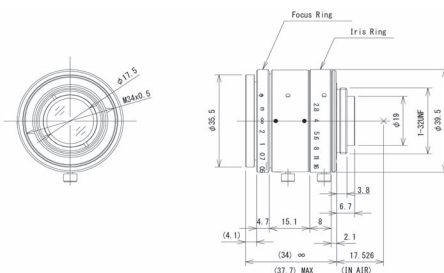

Focal Length	25mm			
Max. Aperture Ratio	1:2.8			
Max. Image Format	14.2mm x 10.4mm (φ 17.6mm)			
Operation Range	Iris F2.8 - F16.0			
	Focus 0.3m - Inf.			
Control	Iris Manual			
	Focus Manual			
Object Dimension at M.O.D.	158.7(H)mm x 116.2(V)mm 1.1"			
Angle of View	D	38.7°	35.4°	24.8°
	H	1.1" 31.7°	1" 28.7°	2/3" 20.0°
	V	23.5°	21.7°	15.0°
Operating Temperature	-10°C ~ +50°C			

Distortion	1.1" 0.3%(y=8.8)	1" 0.2%(y=8.0)	2/3" 0.1%(y=5.5)
Back Focal Length	11.3mm		
Flange Back Length	17.526mm		
Mount	C-Mount		
Filter Size	M34.0 P=0.5mm		
Dimensions	φ 39.5mm x 34mm		
Weight	78g		

Working Distance (mm)	Optical Magnification	Extension Ring (mm)	Field of View(mm)					
			1.1"		1"		2/3"	
			H	V	H	V	H	V
1000	0.026	-	555.5	407.0	500.8	375.7	344.4	258.3
950	0.027	-	527.3	386.3	475.4	356.6	326.9	245.2
900	0.028	-	499.0	365.6	449.9	337.5	309.3	232.0
850	0.030	-	470.7	344.8	424.4	318.3	291.8	218.9
800	0.032	-	442.4	324.1	398.8	299.1	274.2	205.7
750	0.034	-	414.1	303.3	373.3	280.0	256.6	192.5
700	0.037	-	385.7	282.5	347.7	260.8	239.0	179.3
650	0.040	-	357.4	261.7	322.1	241.6	221.5	166.1
600	0.043	-	329.0	240.9	296.6	222.4	203.9	152.9
550	0.047	-	300.7	220.2	271.0	203.2	186.3	139.7
500	0.052	-	272.2	199.3	245.3	184.0	168.6	126.5
450	0.058	-	243.9	178.5	219.8	164.8	151.1	113.3
400	0.066	-	215.5	157.7	194.2	145.6	133.4	100.1
350	0.076	-	187.1	136.9	168.6	126.4	115.8	86.9
300	0.090	-	158.7	116.2	143.0	107.2	98.3	73.7
250	0.108	0.5	131.9	96.5	118.8	89.0	81.6	61.2
200	0.135	1.5	105.6	77.2	95.1	71.3	65.3	48.9
150	0.183	2.5	78.0	57.0	70.3	52.6	48.2	36.1
100	0.281	5.0	50.9	37.2	45.8	34.3	31.4	23.5

Field of View = CCD Size / Optical Magnification

C-MOUNT
1.1" 12MP

1.1" 12 MEGAPIXEL C-MOUNT LENS

MACHINE VISION LENS

- 8, 12, 16, 25, 35, 50mm. 6 Lens Series
- Compatible with 1.1" (φ 17.6mm) Large Format Sensor

- Ultra-High Resolution 12MP
- Compact 1.1" Design (smallest 12MP lens in the industry)

NEW

V3528-MPY

- 1.1"
- 12MP
- FIX
- MANUAL
- FLOATING

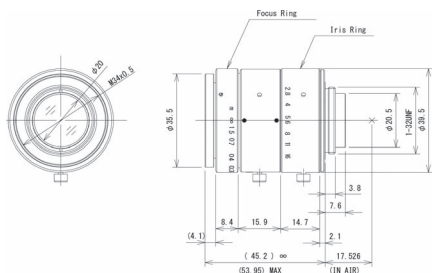

Focal Length	35mm	
Max. Aperture Ratio	1:2.8	
Max. Image Format	14.2mm x 10.4mm (φ 17.6mm)	
Operation Range	Iris	F2.8 - F16.0
	Focus	0.3m - Inf.
Control	Iris	Manual
	Focus	Manual
Object Dimension at M.O.D.	109.3(H)mm x 80.1(V)mm 1.1"	
Angle of View	D	28.2°
	H	22.9°
	V	16.9°
Operating Temperature	1"	25.8°
	2/3"	20.7°
	1/3"	17.9°
Operating Temperature	1"	15.6°
	2/3"	14.3°
	1/3"	10.8°

Distortion	1.1" 0.1%(y=8.8)	1" 0.0%(y=8.0)	2/3" 0.0%(y=5.5)
Back Focal Length	11.7mm		
Flange Back Length	17.526mm		
Mount	C-Mount		
Filter Size	M34.0 P=0.5mm		
Dimensions	φ 39.5mm x 45.1mm		
Weight	103g		

Working Distance (mm)	Optical Magnification	Extension Ring (mm)	Field of View(mm)					
			1.1"		1"		2/3"	
			H	V	H	V	H	V
1000	0.036	-	393.4	288.2	354.6	266.0	243.9	182.9
950	0.038	-	373.0	273.2	336.2	252.2	231.2	173.4
900	0.040	-	352.7	258.4	317.9	238.5	218.6	164.0
850	0.043	-	332.4	243.5	299.6	224.7	206.0	154.5
800	0.046	-	312.1	228.6	281.3	211.0	193.5	145.1
750	0.049	-	291.8	213.8	263.1	197.3	180.9	135.7
700	0.052	-	271.6	198.9	244.8	183.6	168.3	126.3
650	0.057	-	251.3	184.1	226.5	169.9	155.8	116.8
600	0.061	-	231.0	169.2	208.2	156.2	143.2	107.4
550	0.067	-	210.7	154.3	189.9	142.5	130.6	98.0
500	0.075	-	190.4	139.5	171.6	128.8	118.0	88.6
450	0.083	-	170.1	124.6	153.4	115.1	105.5	79.1
400	0.095	-	149.8	109.8	135.1	101.3	92.9	69.7
350	0.110	-	129.5	94.9	116.8	87.6	80.3	60.3
300	0.130	-	109.3	80.1	98.5	73.9	67.8	50.8
250	0.157	1.5	90.4	66.2	81.5	61.1	56.0	42.0
200	0.201	3.0	70.9	51.9	63.9	47.9	43.9	32.9
150	0.277	6.0	51.6	37.7	46.5	34.8	31.9	23.9
100	0.435	15.0	32.9	24.0	29.6	22.2	20.3	15.2

Field of View = CCD Size / Optical Magnification

NEW

V5028-MPY

- 1.1"
- 12MP
- FIX
- MANUAL
- FLOATING

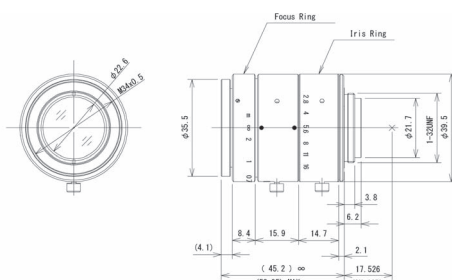

Focal Length	50mm	
Max. Aperture Ratio	1:2.8	
Max. Image Format	14.2mm x 10.4mm (φ 17.6mm)	
Operation Range	Iris	F2.8 - F16.0
	Focus	0.5m - Inf.
Control	Iris	Manual
	Focus	Manual
Object Dimension at M.O.D.	115.9(H)mm x 84.8(V)mm 1.1"	
Angle of View	D	20.0°
	H	16.2°
	V	11.9°
Operating Temperature	1"	18.2°
	2/3"	14.6°
	1/3"	12.6°
Operating Temperature	1"	11.0°
	2/3"	10.1°
	1/3"	7.6°

Distortion	1.1" 0.1%(y=8.8)	1" 0.1%(y=8.0)	2/3" 0.1%(y=5.5)
Back Focal Length	11.9mm		
Flange Back Length	17.526mm		
Mount	C-Mount		
Filter Size	M34.0 P=0.5mm		
Dimensions	φ 39.5mm x 45.1mm		
Weight	107g		

Working Distance (mm)	Optical Magnification	Extension Ring (mm)	Field of View(mm)					
			1.1"		1"		2/3"	
			H	V	H	V	H	V
1000	0.055	-	257.9	188.9	232.5	174.4	159.8	119.9
950	0.058	-	243.7	178.5	219.7	164.7	151.0	113.3
900	0.062	-	229.5	168.1	206.9	155.1	142.2	106.7
850	0.066	-	215.3	157.6	194.0	145.5	133.4	100.0
800	0.071	-	201.1	147.2	181.2	135.9	124.6	93.4
750	0.076	-	186.9	136.8	168.4	126.3	115.8	86.8
700	0.082	-	172.7	126.4	155.6	116.7	107.0	80.2
650	0.090	-	158.5	116.0	142.8	107.1	98.2	73.6
600	0.099	-	144.2	105.6	130.0	97.5	89.4	67.0
550	0.109	-	130.0	95.2	117.2	87.9	80.6	60.4
500	0.123	-	115.9	84.8	104.4	78.3	71.8	53.8
450	0.138	1.0	103.1	75.4	92.9	69.6	63.8	47.9
400	0.158	2.0	89.9	65.8	81.0	60.7	55.7	41.7
350	0.181	5.0	78.5	57.4	70.7	53.0	48.6	36.4
300	0.222	6.0	64.2	47.0	57.8	43.3	39.7	29.8
250	0.276	10.0	51.7	37.8	46.6	34.9	32.0	24.0
200	0.373	15.0	38.2	27.9	34.4	25.8	23.6	17.7
150	0.583	25.0	24.5	17.9	22.1	16.5	15.1	11.3
100	1.255	61.5	11.3	8.3	10.2	7.7	7.0	5.3

Field of View = CCD Size / Optical Magnification